

**VENUE  
HIRE**



**AVIVA studios**





Aviva Studios is a global destination for arts, music and culture – and an event venue like no other.

Borne out of Manchester International Festival, at Aviva Studios, collaborate with the very best event, production and technical teams to bring your vision to life.

Our spaces are without limits. From product launches and brand activations to fashion shows, gigs and public events, do something a bit different here.

In the heart of Manchester's new and vibrant neighbourhood of St John's, there's no better place to put on a proper show.

And if you want to make a lasting difference – to people, communities or the planet – join us and invent a better tomorrow together.

**Planning your next event?  
Now's the time to get in touch.**

[DISCOVER OUR VENUE ↗](#)

[HEAR MORE ABOUT OUR VENUE ↗](#)





# OUR LOCATION

An aerial photograph of Manchester, UK, showing a mix of modern and historic architecture. In the foreground, a row of red brick terraced buildings with white window frames and arched doorways. Behind them, a large, modern, white, angular building with a flat roof. To the left, a tram is visible on a bridge. In the background, several tall, modern skyscrapers, including the Beetham Tower, rise against a clear blue sky.

Aviva Studios sits at the heart of Manchester, a proud global city with a distinct local feel.

A city that never stands still, with its rich history of 'firsts' and ever-expanding diverse cultural offer.

Located on the River Irwell in the city's new St John's neighbourhood, we are a place to gather, meet and innovate.

And you'll find us easily. Our range of transport links include train and tram, bike, bus and car - connecting you to all that the region has to offer and beyond.



# ST. JOHN'S: FUTURE PROSPECTS

VIEW ON MAPS ↗

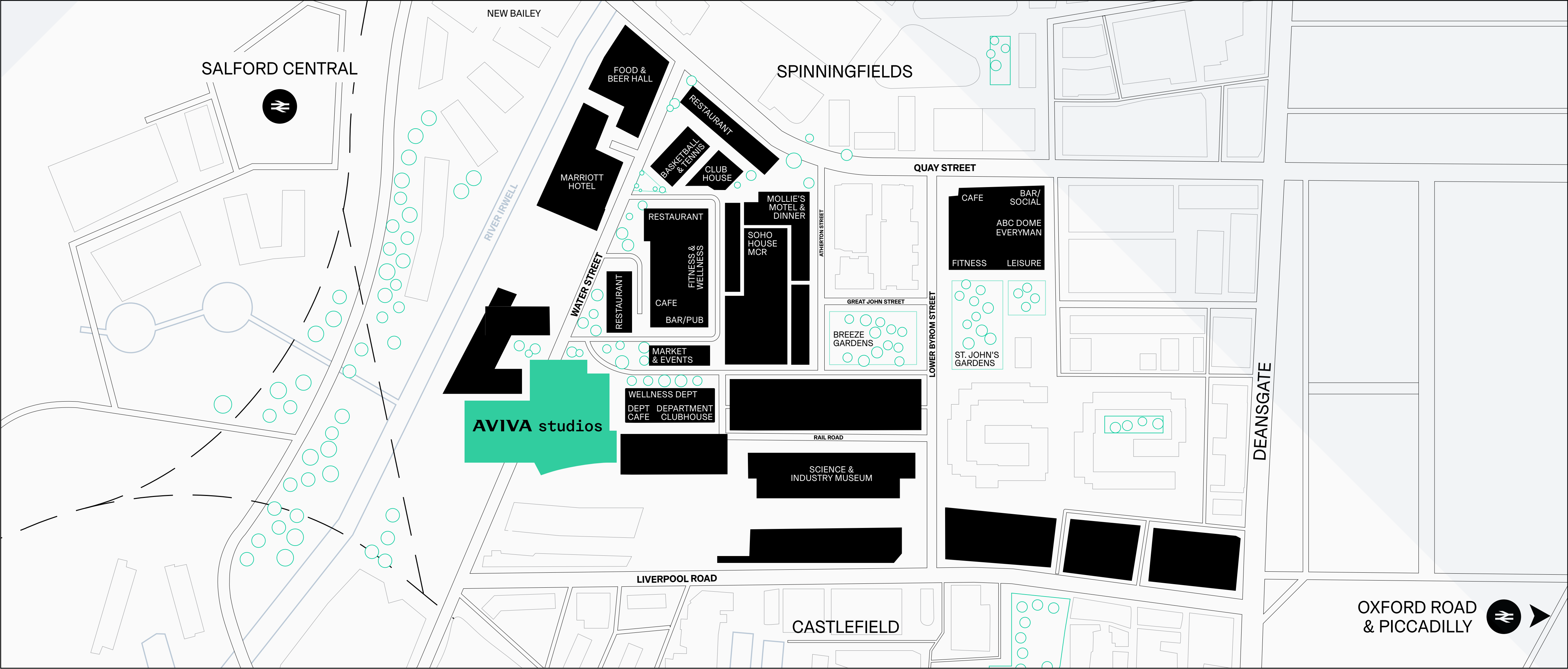



# IMPACT BEYOND THE STAGE

Supported by



Factory Academy – Broadcast and Film course

Aviva Studios is so much more than a venue. As the home of Factory International, it's a place where content and programmes on and off the stage will make a lasting difference – to people, communities and in terms of sustainability.

If you share our commitment to diversity, community, sustainability or the future of the arts, then join us and invent a better tomorrow together.



Victoria Jane at MIF21. Image © Priti Shikotra



Factory Academy. Image © Chris Payne



# BUILDING

- ENTRANCE/EXIT
- PUBLIC REALM
- PHYSICAL LINK TO SIM

## BACK OF HOUSE

Backstage supporting spaces for visiting artists, companies and events staff.

A retractable wall allows the Warehouse to be reconfigured into the North and South Warehouse, providing acoustic separation and allowing multi-use.

## THE WAREHOUSE

A supersized space (33m×66m), capable of holding audiences of up to 2,000 (standing)

## THE LAW FAMILY HALL

A more conventional theatre space split between a fixed balcony and removable stalls, capable of accommodating between up to 1230 people depending on configuration.

## SOCIAL AND HALL FOYERS

A large volume at ground floor level under the Warehouse with additional Foyer spaces at Level 2 and 3, wrapping around The Law Family Hall.

## UNDERCROFT

Outdoor and undercover public realm will support the Factory International programme as well as providing visitors with a setting to enjoy Aviva Studios and the surrounding environment, including the River Irwell – an almost unique experience in central Manchester.

DISCOVER OUR VENUE ➤



# THE LAW FAMILY HALL

An innovative theatre space at the heart of the venue, which has been specifically designed to allow for a more immersive relationship between stage and audience.



Accommodates up to **1,230 people**.



AV, stage and **lighting inclusions** available.



Varying stage **depths**.



**Flexible stage seating**, which can also be removed entirely.



**Tiered seating**.



Wheelchair **access** on all levels.



Foyer bars, with impressive **views across the city**.



Proscenium wall connecting the Hall to the Warehouse – **fully acoustically soundproofed** when closed or can be lifted to allow a full building takeover.

The supersized stage connects The Law Family Hall with the Warehouse, meaning you can really think big – from awards ceremonies and conferences to hybrid events



# THE LAW FAMILY HALL

- 1

1ST FLOOR FOYER
- 2

LOWER STALLS
- 3

BALCONY SEATING
- 4

2ND FLOOR FOYER
- 5

TRUCK LIFT

Lifts

Stairs

Accessible

Toilets

Entrance

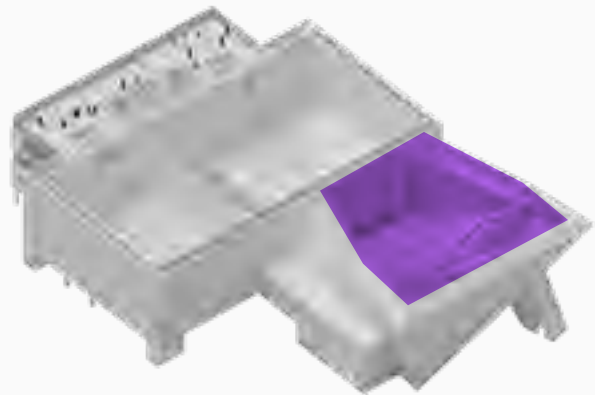
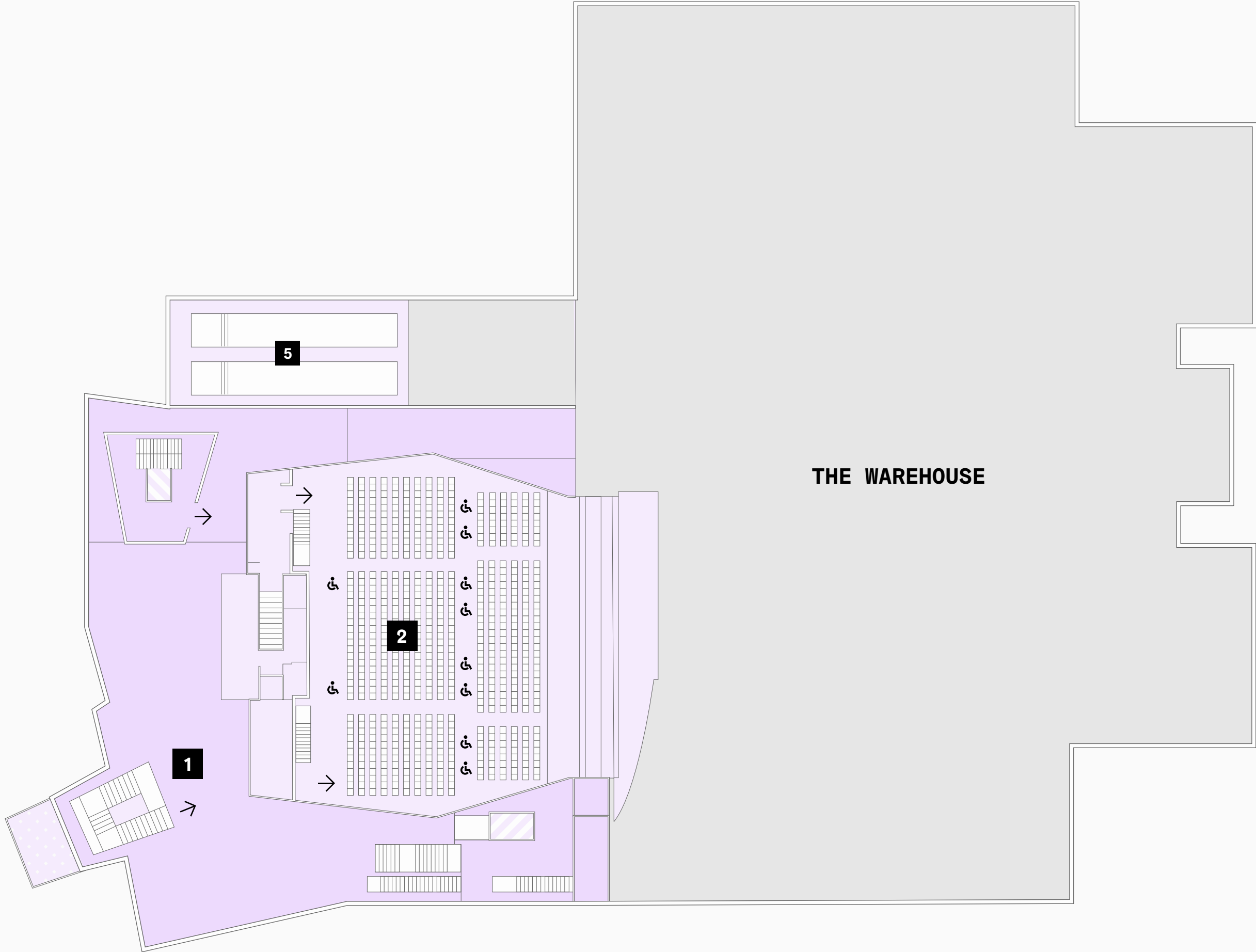
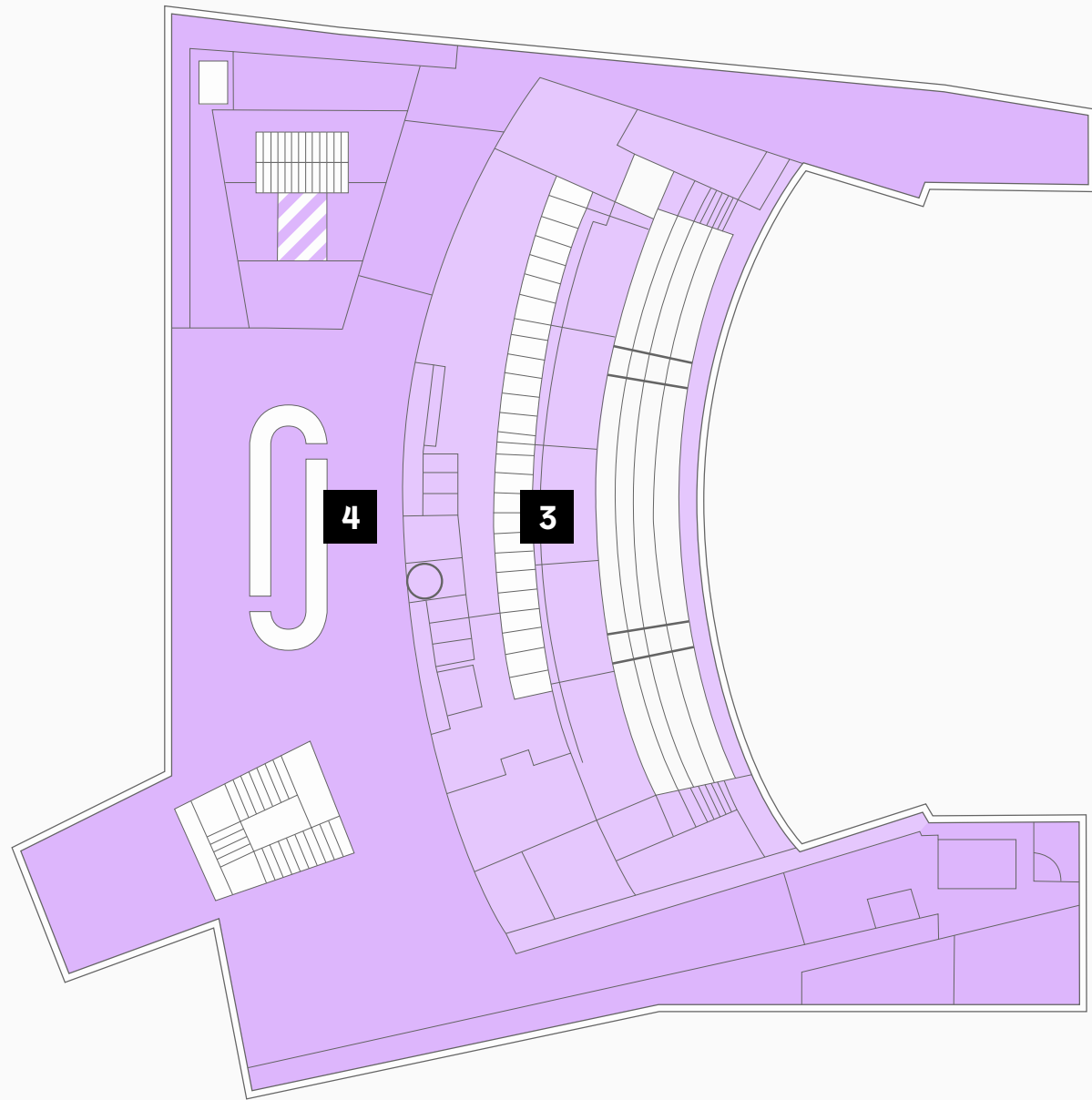

## HALL

Seated up to	1230
Stalls	590
Circle	640

Seated Circle and standing stalls up to	1554
Standing Stalls	914
Seated Circle	640

Area (m²)	570
Area with Stage	320



# THE WAREHOUSE

Connected to The Law Family Hall by the stage, the Warehouse is a flexible space — think epic concerts, large conferences and gala dinners. A true blank canvas, designed to accommodate a myriad of different events.



Accommodates up to **2,000 people**.



A **retractable wall** allows you to reconfigure the space into the North and South Warehouse.



**Acoustic separation** allows multi-use across the venue at any one time.



Direct articulated **truck access**.



Anchor points in the wall to **support any kind of mount or rigging**.



**Universal technical grid** across the ceiling.



# THE WAREHOUSE

- 1

WAREHOUSE NORTH
- 2

WAREHOUSE SOUTH
- 3

TRUCK LIFT
- 4

MOVEABLE WALL
- 5

FACILITIES

Lifts

Stairs

Accessible

Toilets

Entrance

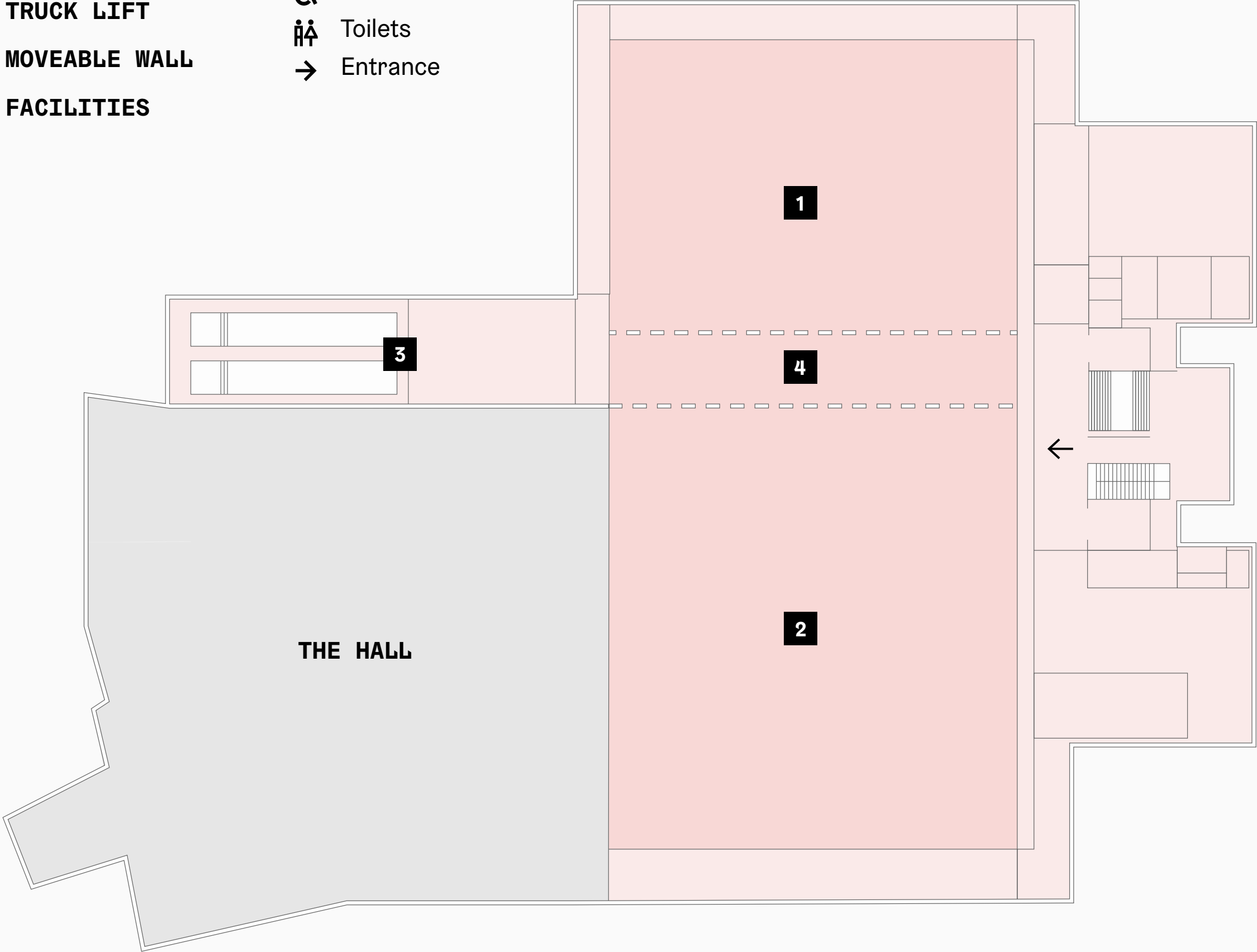

FIRST FLOOR

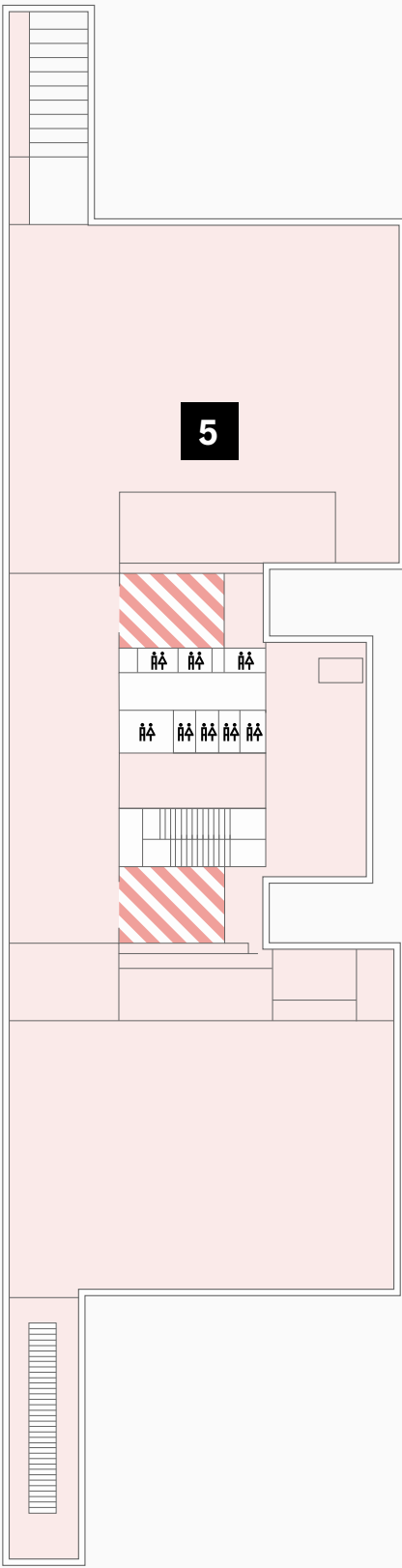

BACK OF HOUSE TOWERS

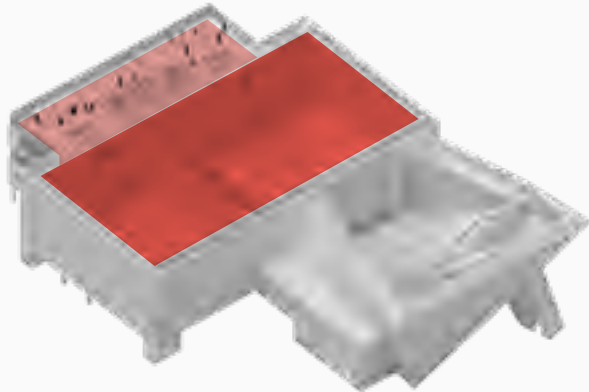

WAREHOUSE	
Standing Reception	2000
Theatre	1500
Banquet	696
Height (max)	21m
Height (min)	20m
Length	64.1m
Width	32.7m
Area (m²)	2096.1

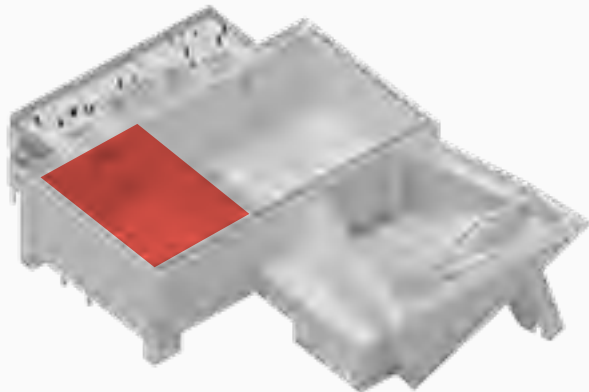

NORTH	
Standing Reception	900
Theatre	600
Cabaret (tables of 8)	224
Banquet (tables of 10)	280
Height (max)	21m
Height (min)	20m
Length	32.7m
Width	23.6m
Area (m²)	771.7

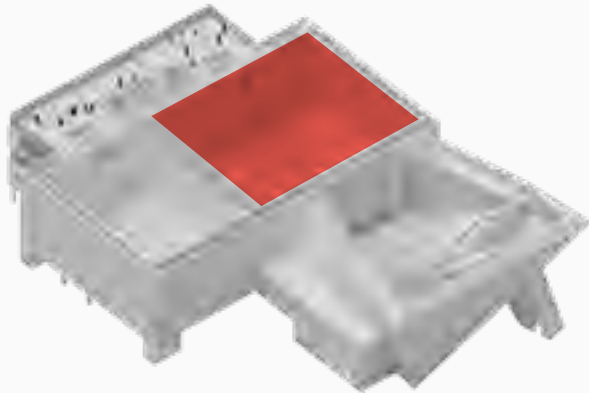

SOUTH	
Standing Reception	1100
Theatre	900
Cabaret (tables of 8)	360
Banquet	450
Height (max)	20.5m
Height (min)	20.5m
Length	35.8m
Width	32.7m
Area (m²)	1170.7



# PUBLIC REALM / THE SOCIAL

With beautiful south-facing views to the River Irwell, River Square is a truly unique outdoor events space ideal for pop-up brand activations, experiential marketing campaigns, live music or markets.



Expected annual footfall of **850,000**.



Supplementing River Square, the Undercroft runs below Aviva Studios, creating a covered external space and enabling activities to take place year-round.



**External power supply.**



**WiFi provision** within the Undercroft.



**Connected to neighbouring St. John's** business and leisure district.



Up to **2,100 m<sup>2</sup>** of space to be hired across the Public Realm.

Leading into Aviva Studios, The Social is a ground-floor foyer nestled under the arch of The Law Family Hall and The Warehouse. A unique and versatile reception space combines a bright and airy atmosphere with an industrial feel; it also includes a series of listed arches – the only pre-existing feature incorporated into the building.



# PACKAGES

The uniqueness and flexibility of our spaces means we can curate a package to suit any vision.

- Awards and dinners
- Brand and product launches
- Conferences and exhibitions
- Fashion events
- Filming and broadcast
- Standing receptions
- Brand activations
- Christmas parties

Looking to 'wow'? Get in touch and discuss a bespoke package for your event at **events@factoryinternational.org** or for music enquiries at **music@factoryinternational.org**



Standing receptions

image © Mariana Yáñez



Fashion events

image © Rudy Issa

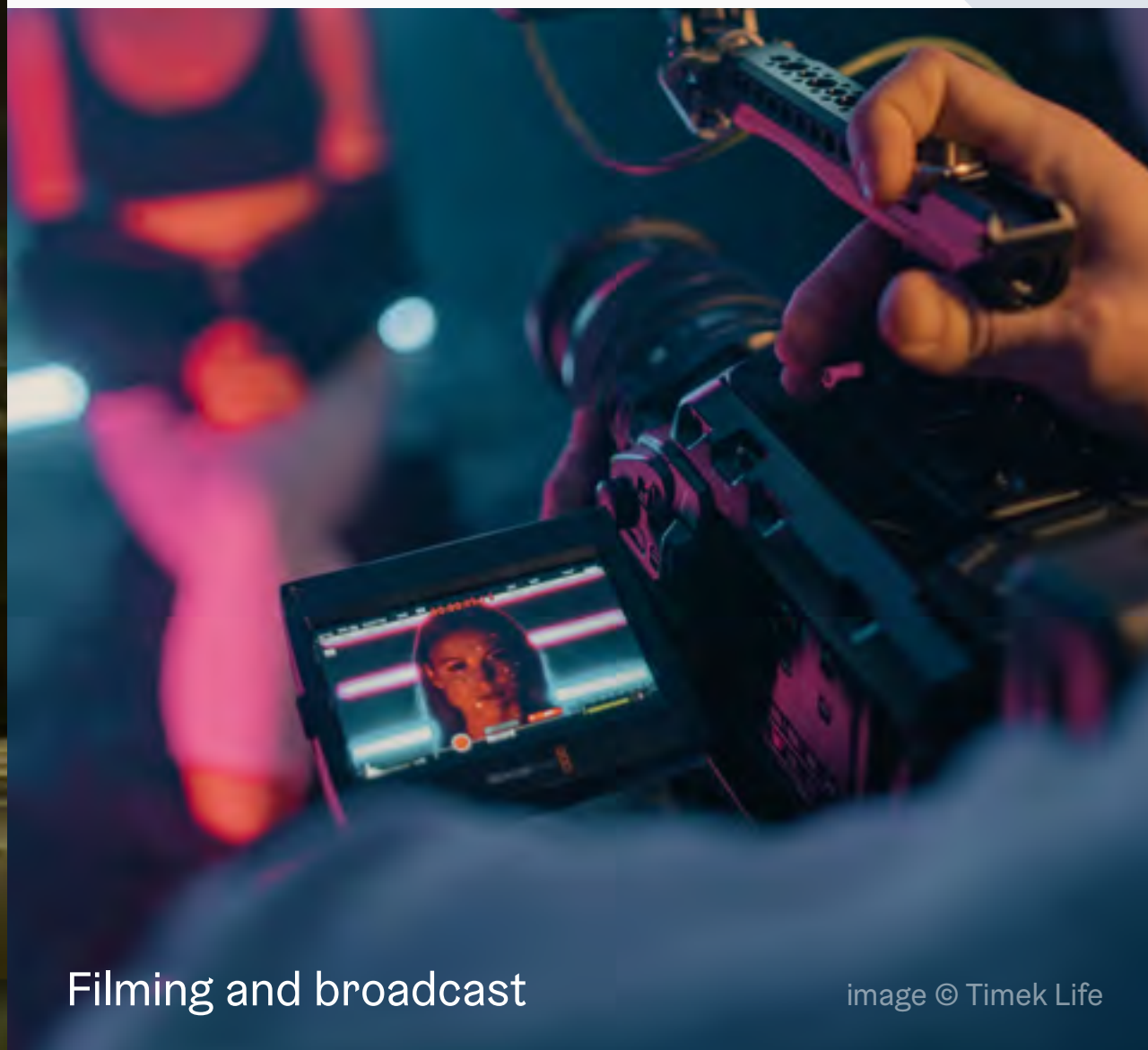

Filming and broadcast

image © Timek Life



Conferences and exhibitions

Photo by Marco Cappelletti, courtesy of OMA and Factory International



# APPROACH

A wide-angle photograph of a stage performance. In the foreground, the silhouettes of an audience are visible, seated in rows. The stage is a large, flat, light-colored surface. A large, circular, glowing light fixture hangs from the ceiling, casting a warm, golden light over the stage. Numerous dancers in black outfits are scattered across the stage, some in dynamic poses, others on the floor. A single dancer in a bright red outfit is visible on the right side of the stage. The background is dark, with some stage equipment visible on the left.

Creativity runs through our veins.

Be supported and inspired by Factory International's world-class creative community.

When you hire any of our spaces, our in-house event, technical and production teams will be on hand to help seamlessly bring your vision to life.

Our technical expertise means you can think big; whether it's innovative tech, lighting or sound – or even transmitting your event around the world – we'll help you get creative.



# ACCESS

A photograph of an outdoor event with a large crowd. In the foreground, a person wearing a bright pink jacket, a grey cap, and patterned trousers is seated in a red and black wheelchair. They are looking towards the right. Next to them, a woman with long brown hair, wearing a patterned dress and glasses, is seated on a concrete block and looking at her phone. The background is filled with many other people sitting on the grass, some on chairs and some on blankets. The scene is bright and sunny.

At Aviva Studios, we're driven to make everything we do more inclusive, accessible and diverse.

This includes making sure our venue is comfortable and easy to visit for everyone. We have a dedicated Access Manager who has overall responsibility for ensuring the venue is as accessible as possible, but also ask everyone who works with us to put access at the heart of their events.

To speak to someone directly, you can contact our events team at [events@factoryinternational.org](mailto:events@factoryinternational.org)



# SUSTAINABILITY



On a path towards zero-carbon activity by 2028, we're working with industry partners to test and pilot innovative sustainability technology at Aviva Studios.

We ask all our partners to consider how they can reduce the environmental impact of their events – from encouraging sustainable travel to and from the venue to considering the materials they use. Our experienced events team are always on hand to provide guidance and support in this area.

More information on our sustainability approach or to speak to someone directly, you can contact our events team at [\*\*events@factoryinternational.org\*\*](mailto:events@factoryinternational.org)



**AVIVA** studios

