

VENUE HIRE

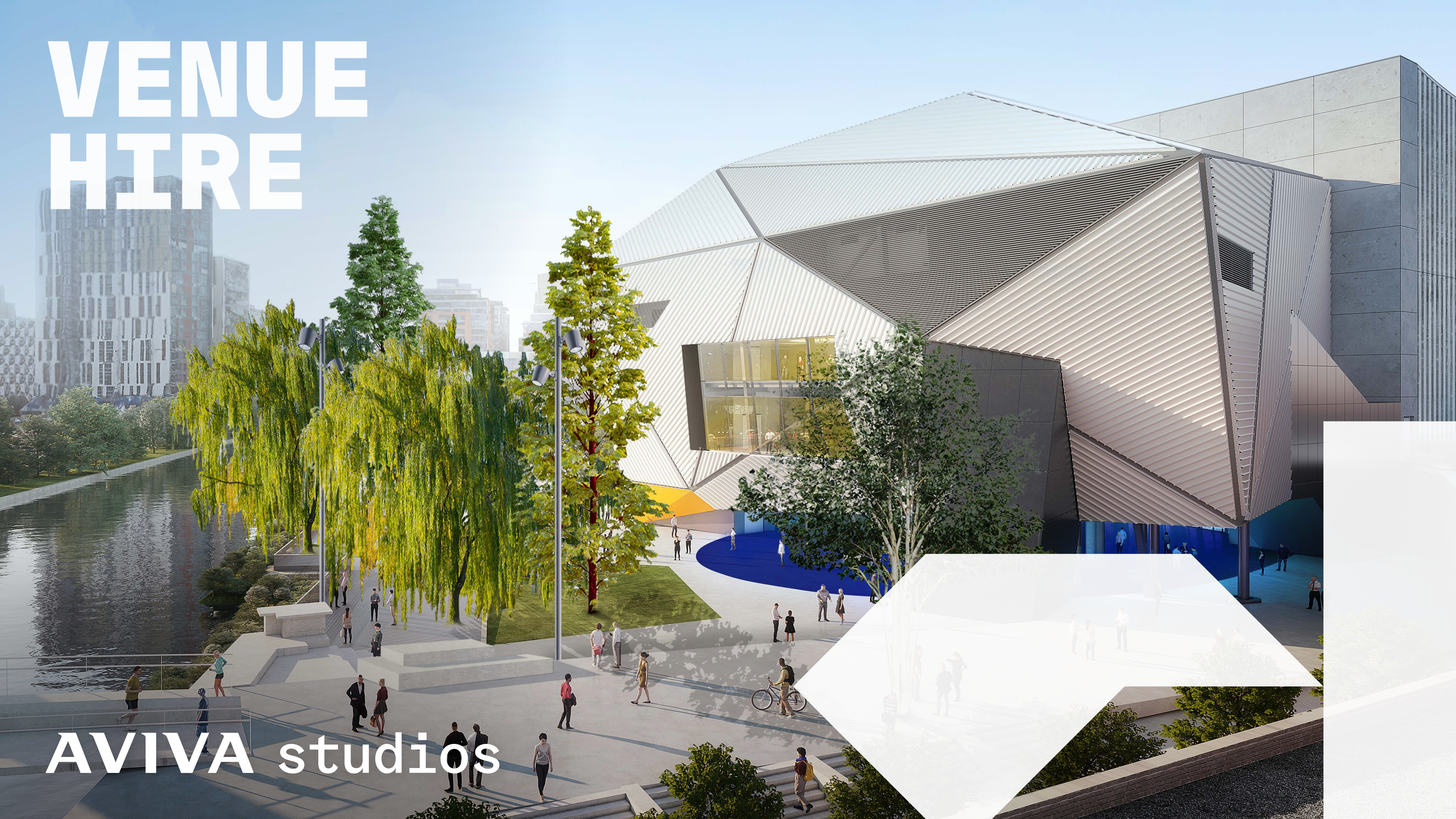

AVIVA studios

THE VENUE



Aviva Studios is a global destination for arts, music and culture - and an event venue like no other.

Borne out of Manchester International Festival, at Aviva Studios, collaborate with the very best event, production and technical teams to bring your vision to life.

Our spaces are without limits. From product launches and brand activations to fashion shows, gigs and public events, do something a bit different here.

In the heart of Manchester's new and vibrant neighbourhood of St John's, there's no better place to put on a proper show.

And if you want to make a lasting difference – to people, communities or the planet – join us and invent a better tomorrow together.

**Planning your next event?
Now's the time to get in touch.**

[HEAR MORE ABOUT OUR VENUE ↗](#)



Warehouse

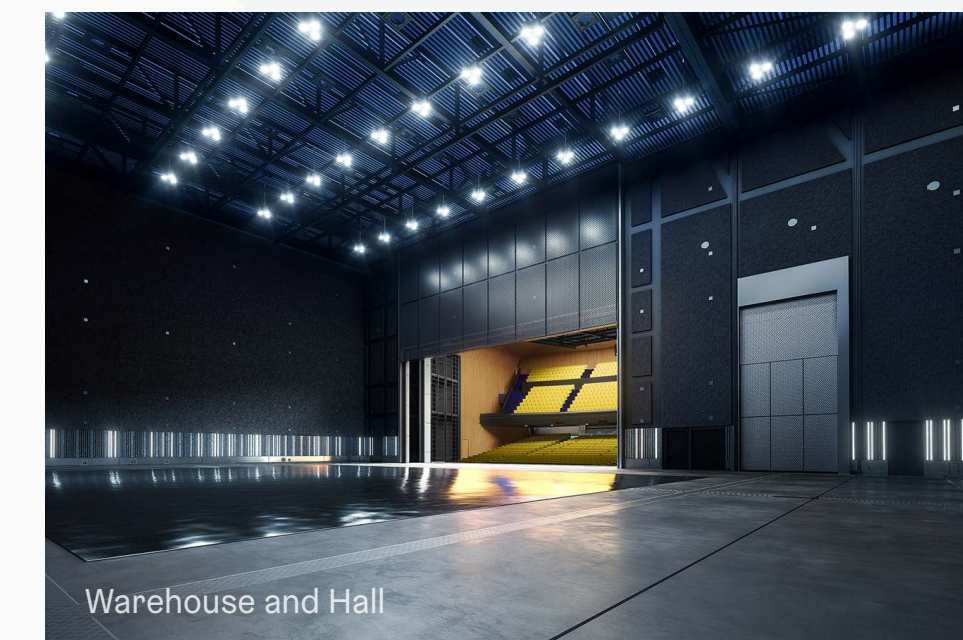

Warehouse and Hall

OUR LOCATION

A nighttime photograph of a modern cityscape, likely Manchester, featuring several tall buildings with illuminated windows and balconies. In the foreground, there's a river or canal with a bridge, and some greenery. The sky is dark, and the overall atmosphere is urban and vibrant.

Aviva Studios sits at the heart of Manchester, a proud global city with a distinct local feel.

A city that never stands still, with its rich history of 'firsts' and ever-expanding diverse cultural offer.

Located on the River Irwell in the city's new St John's neighbourhood, we are a place to gather, meet and innovate.

And you'll find us easily. Our range of transport links include train and tram, bike, bus and car - connecting you to all that the region has to offer and beyond.

ST. JOHN'S: FUTURE PROSPECTS

[VIEW ON MAPS ↗](#)

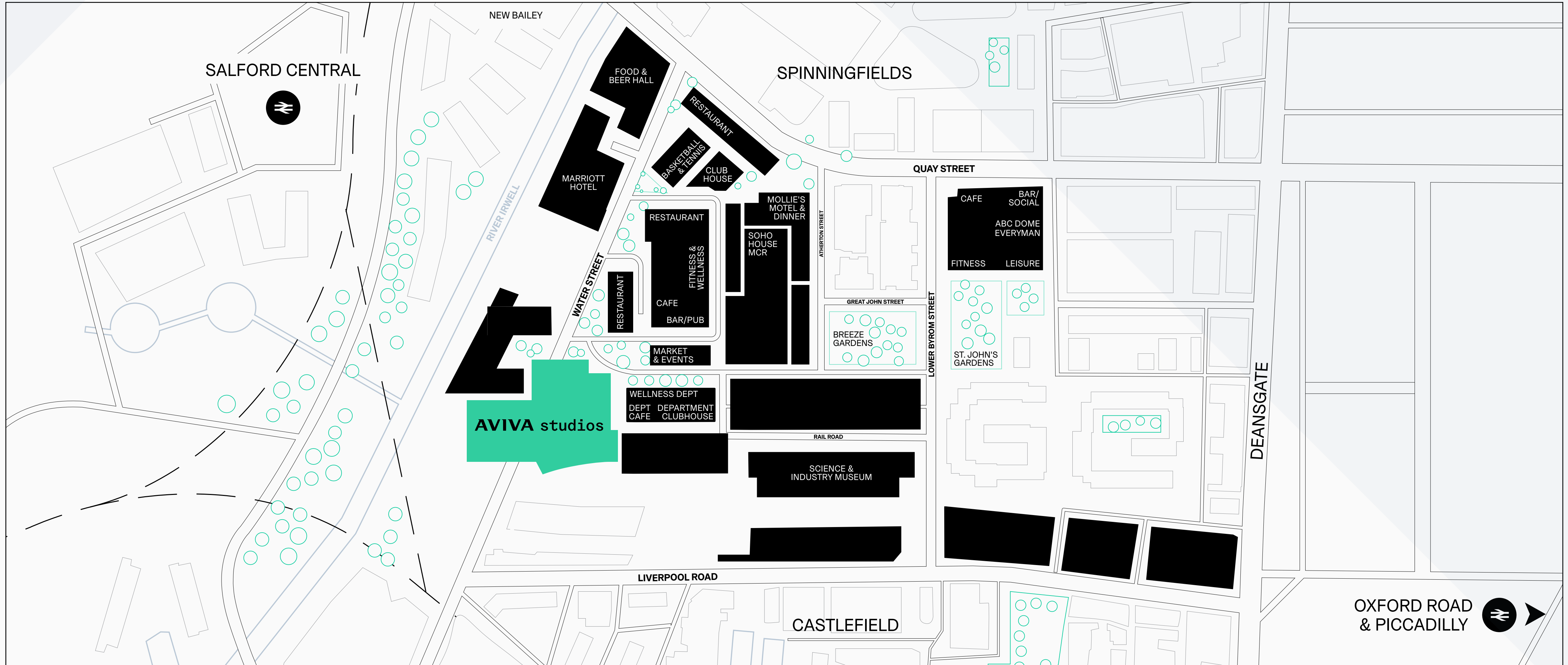

IMPACT BEYOND THE STAGE

Supported by



Factory Academy – Broadcast and Film course



Victoria Jane at MIF21. Image © Priti Shikotra

Aviva Studios is so much more than a venue. As the home of Factory International, it's a place where content and programmes on and off the stage will make a lasting difference – to people, communities and in terms of sustainability.

If you share our commitment to diversity, community, sustainability or the future of the arts, then join us and invent a better tomorrow together.



Factory Academy. Image © Chris Payne

BUILDING

- ENTRANCE/EXIT
- PUBLIC REALM
- PHYSICAL LINK TO SIM

BACK OF HOUSE

Backstage supporting spaces for visiting artists, companies and events staff.

A retractable wall allows the Warehouse to be reconfigured into the North and South Warehouse, providing acoustic separation and allowing multi-use.

THE WAREHOUSE

A supersized space (33m×66m), capable of holding audiences of up to 5,000 (standing)

THE HALL

A more conventional theatre space split between a fixed balcony and removable stalls, capable of accommodating between up to 1,264-1,565 people depending on configuration.

SOCIAL AND HALL FOYERS

A large volume at ground floor level under the Warehouse with additional Foyer spaces at Level 2 and 3, wrapping around The Hall.

UNDERCROFT

Outdoor and undercover public realm will support the Factory International programme as well as providing visitors with a setting to enjoy Aviva Studios and the surrounding environment, including the River Irwell – an almost unique experience in central Manchester.

[DISCOVER OUR VENUE ↗](#)

HALL

An innovative theatre space at the heart of the venue, which has been specifically designed to allow for a more immersive relationship between stage and audience.



Accommodates up to **1,565 people**.



AV, stage and **lighting inclusions** available.



Varying stage **depths**.



Flexible stage seating, which can also be removed entirely.



Tiered seating.



Wheelchair **access** on all levels.



Foyer bars, with impressive **views across the city**.





Proscenium wall connecting the Hall to the Warehouse – **fully acoustically soundproofed** when closed or can be lifted to allow a full building takeover.

The supersized stage connects the Hall with the Warehouse, meaning you can really think big – from awards ceremonies and conferences to hybrid events

HALL

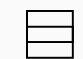
- 1** 1ST FLOOR FOYER
- 2** LOWER STALLS
- 3** BALCONY SEATING
- 4** 2ND FLOOR FOYER
- 5** TRUCK LIFT

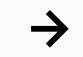
-  Lifts
-  Stairs
-  Accessible
-  Toilets
-  Entrance

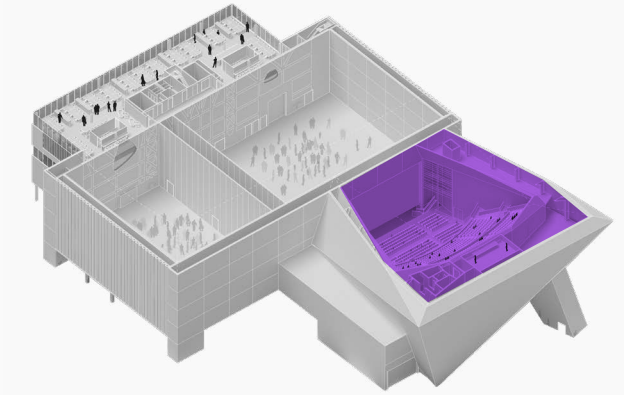
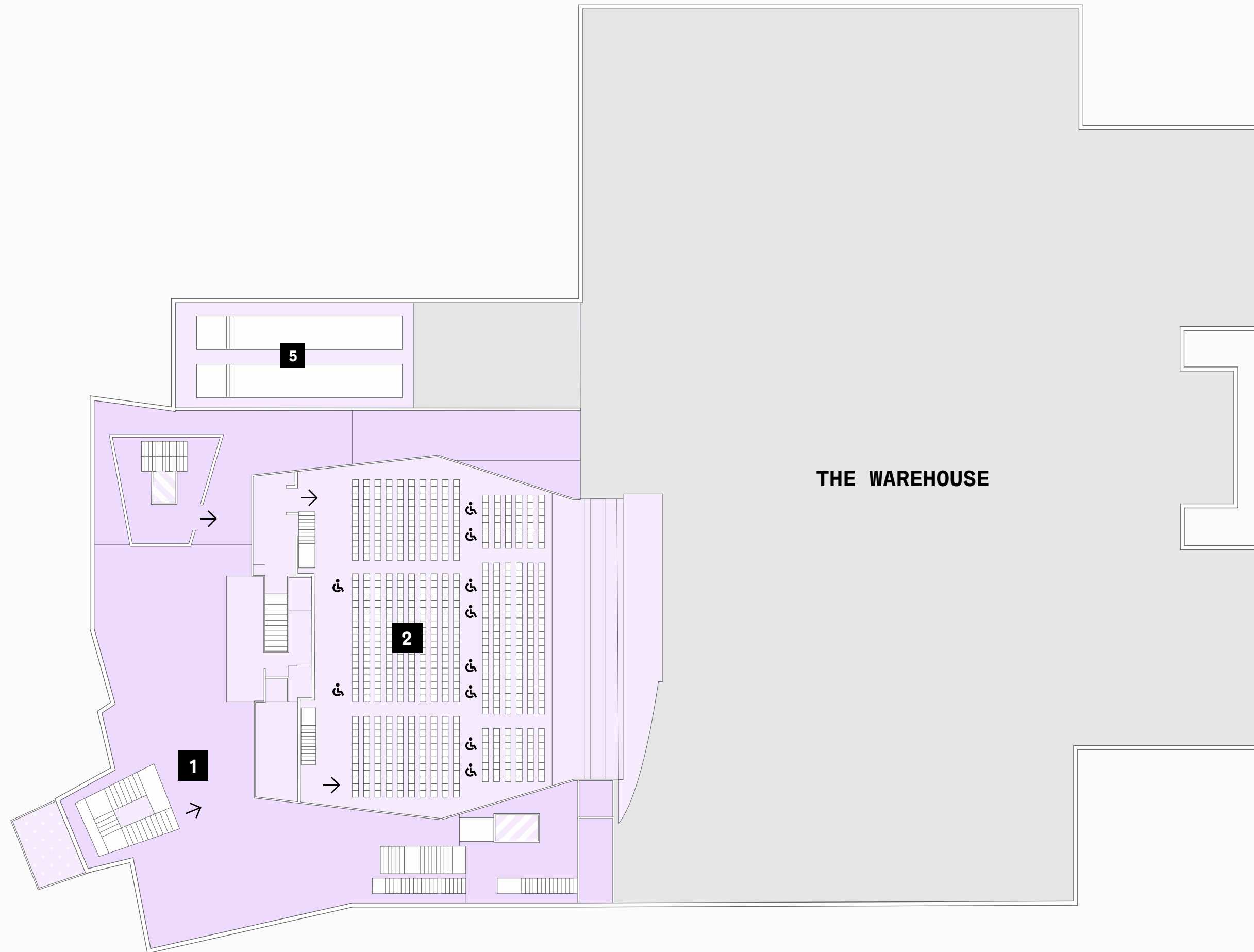
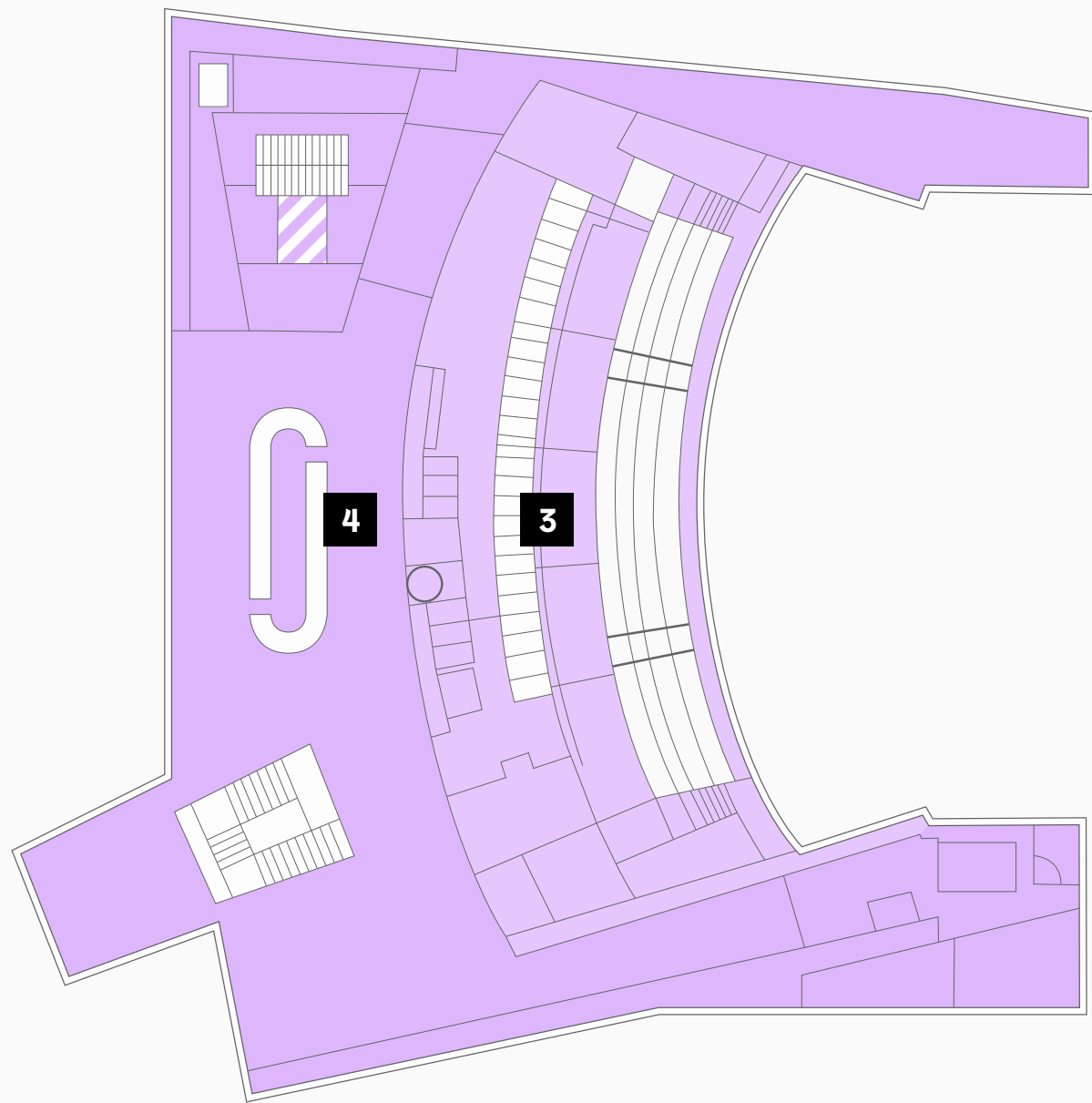

HALL

Standing Reception	Up to 1,565
Theatre	Up to 1,264
Area (m2)	580

THE WAREHOUSE

Connected to the Hall by the stage, the Warehouse is a flexible space — think epic concerts, large conferences and gala dinners. A true blank canvas, designed to accommodate a myriad of different events.



Accommodates up to **5,000 people**.



A **retractable wall** allows you to reconfigure the space into the North and South Warehouse.



Acoustic separation allows multi-use across the venue at any one time.



Direct articulated **truck access**.







Anchor points in the wall to **support any kind of mount or rigging**.



Universal technical grid across the ceiling.

THE WAREHOUSE

- 1 WAREHOUSE NORTH**
- 2 WAREHOUSE SOUTH**
- 3 TRUCK LIFT**
- 4 MOVEABLE WALL**
- 5 FACILITIES**

-  Lifts
-  Stairs
-  Accessible
-  Toilets
-  Entrance

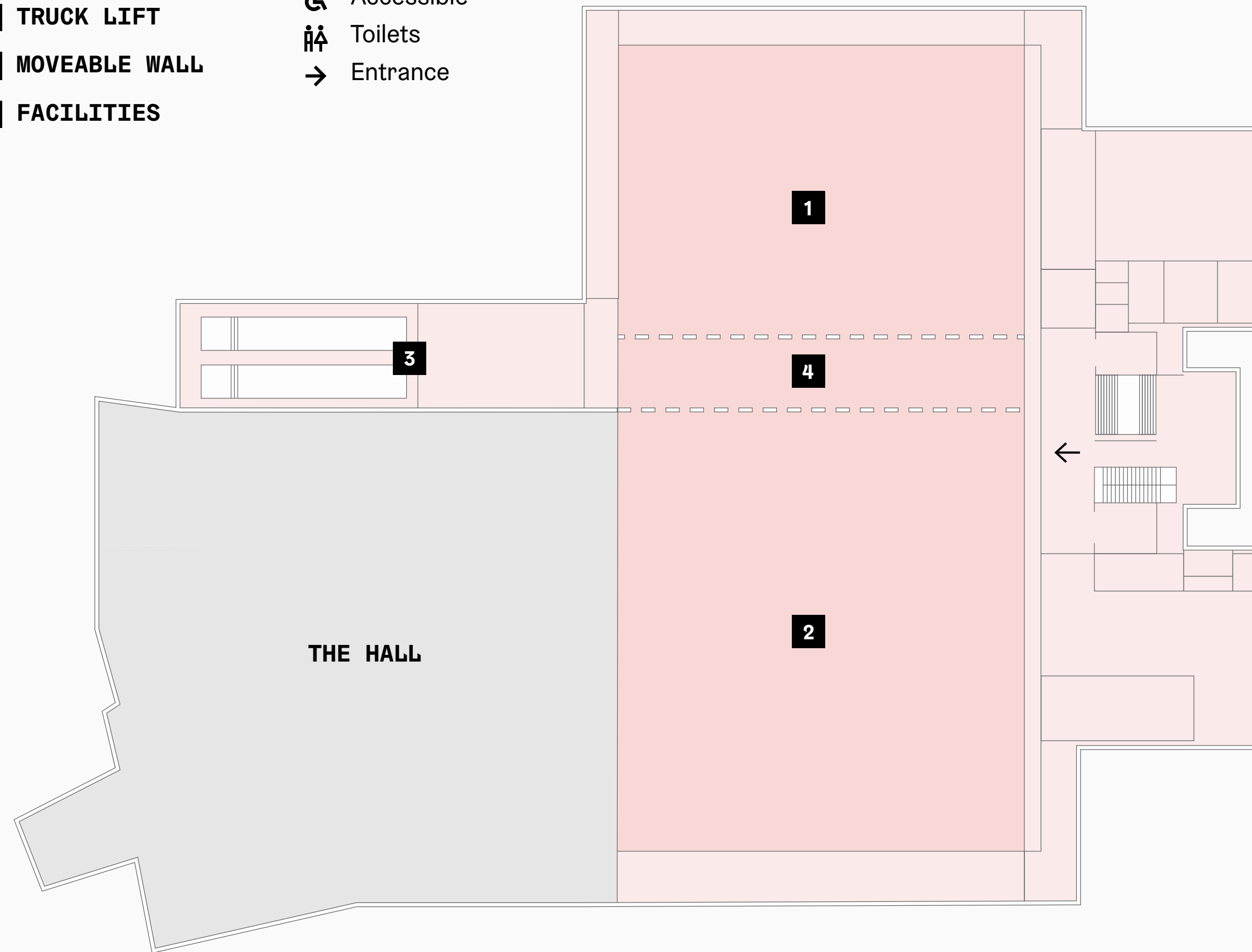

FIRST FLOOR

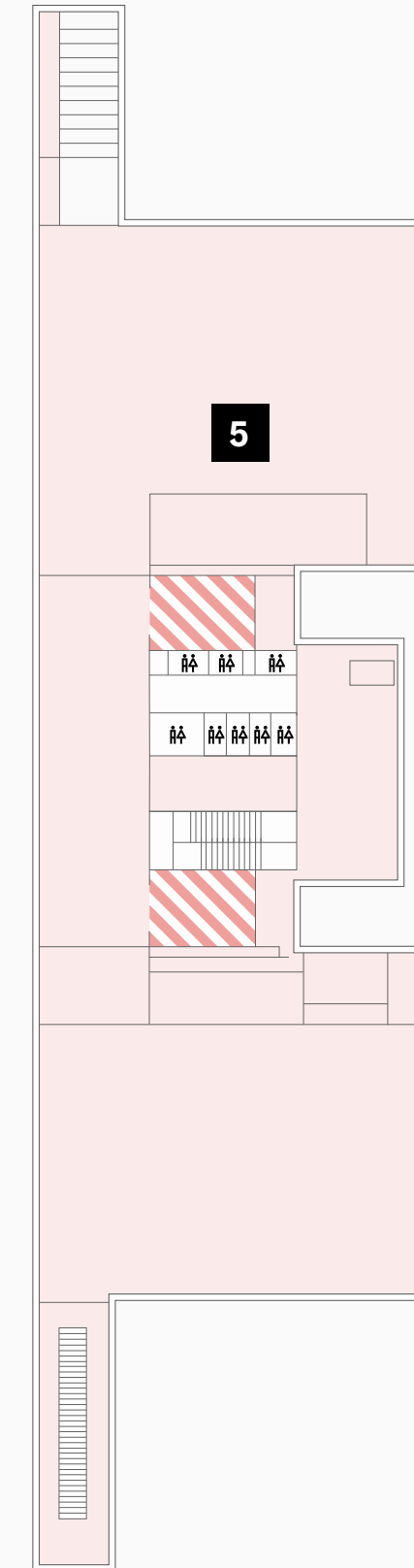

BACK OF HOUSE TOWERS

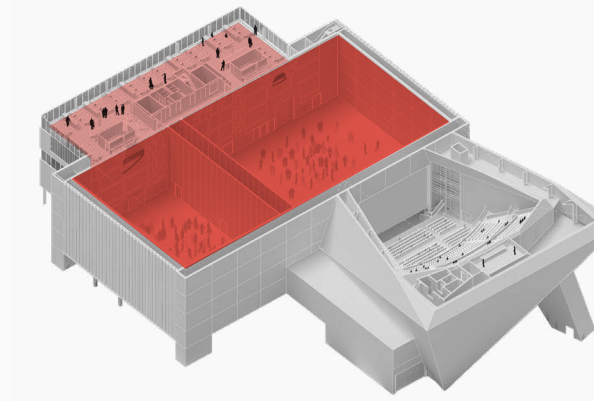

WAREHOUSE

Standing Reception	5000
Theatre	2400
Banquet	950
Height (max)	20.5m
Height (min)	20.5m
Length	64.1m
Width	32.7m
Area (m ²)	2096.1

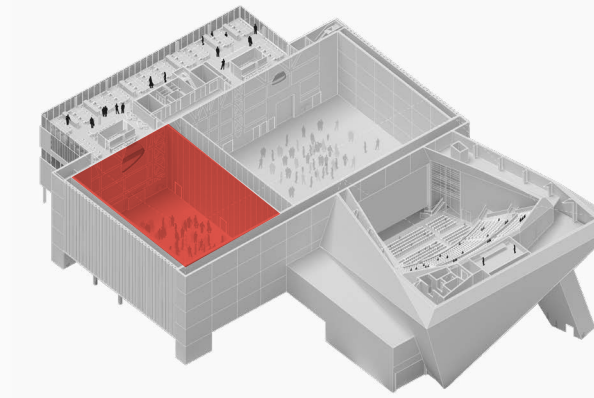

NORTH

Standing Reception	2000
Theatre	900
Banquet	330
Height (max)	20.5m
Height (min)	20.5m
Length	32.7m
Width	23.6m
Area (m ²)	771.7

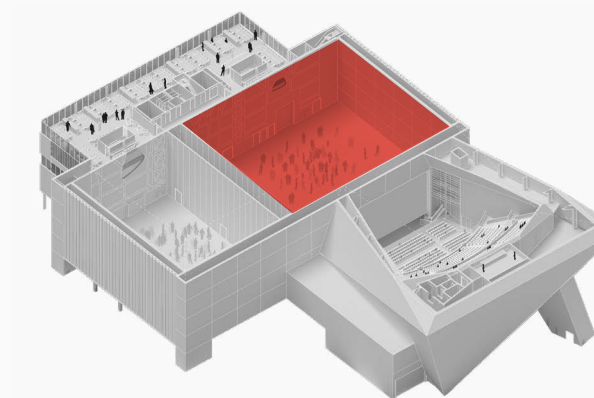

SOUTH

Standing Reception	3000
Theatre	1500
Banquet	510
Height (max)	20.5m
Height (min)	20.5m
Length	35.8m
Width	32.7m
Area (m ²)	1170.7

PUBLIC REALM / THE SOCIAL

With beautiful south-facing views to the River Irwell, River Square is a truly unique outdoor events space ideal for pop-up brand activations, experiential marketing campaigns, live music or markets.



Expected annual footfall of **850,000**.



Supplementing River Square, the Undercroft runs below Aviva Studios, creating a covered external space and enabling activities to take place year-round.



External power supply.



WiFi provision within the Undercroft.



Connected to neighbouring St. John's business and leisure district.



Up to **2,100 m²** of space to be hired across the Public Realm.

Leading into Aviva Studios, The Social is a ground-floor foyer nestled under the arch of The Hall and The Warehouse. A unique and versatile reception space combines a bright and airy atmosphere with an industrial feel; it also includes a series of listed arches – the only pre-existing feature incorporated into the building.

PACKAGES

The uniqueness and flexibility of our spaces means we can curate a package to suit any vision.

- Awards and dinners
- Brand and product launches
- Conferences and exhibitions
- Fashion events
- Filming and broadcast
- Standing receptions
- Brand activations
- Christmas parties

Looking to 'wow'? Get in touch and discuss a bespoke package for your event at events@factoryinternational.org or for music enquiries at music@factoryinternational.org



Standing receptions

image © Mariana Yáñez



Fashion events

image © Rudy Issa

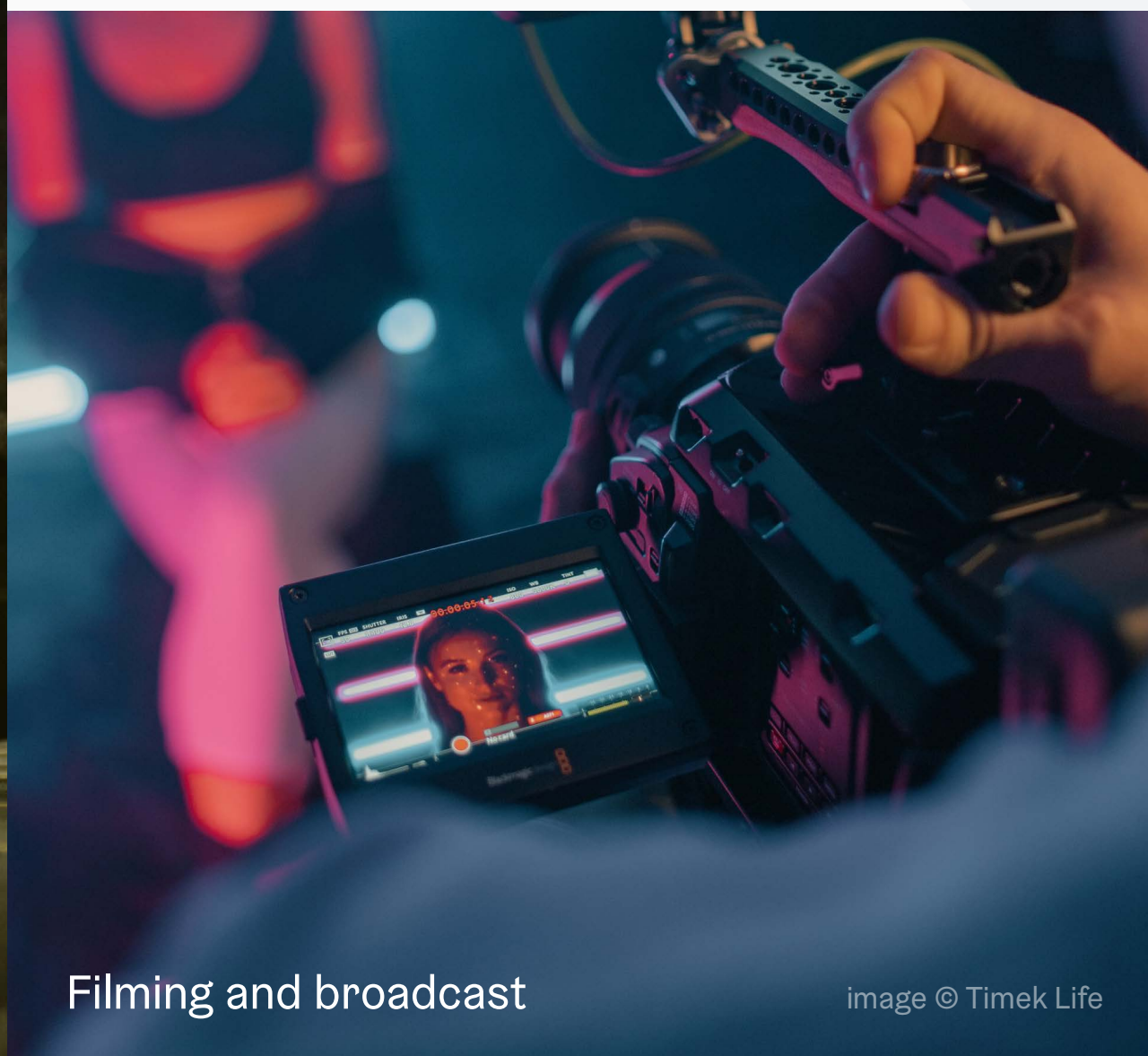

Filming and broadcast

image © Timek Life

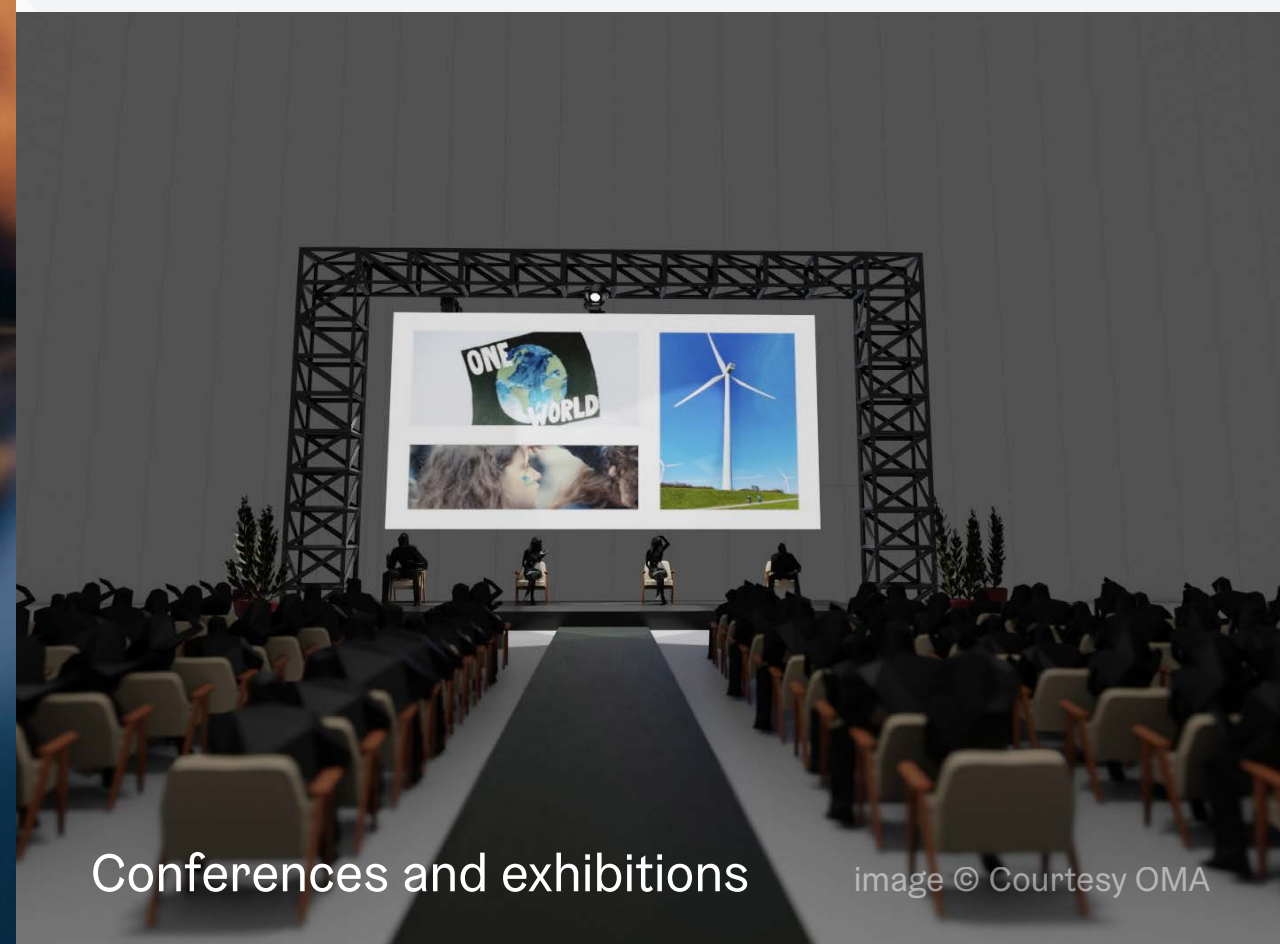

Conferences and exhibitions

image © Courtesy OMA

APPROACH



Creativity runs through our veins.

Be supported and inspired by Factory International's world-class creative community.

When you hire any of our spaces, our in-house event, technical and production teams will be on hand to help seamlessly bring your vision to life.

Our technical expertise means you can think big; whether it's innovative tech, lighting or sound – or even transmitting your event around the world – we'll help you get creative.

ACCESS

A photograph showing a person in a motorized wheelchair on a paved surface. Another person is standing next to them, partially visible. The image is used as a background for the text on the right side of the page.

At Aviva Studios, we're driven to make everything we do more inclusive, accessible and diverse.

This includes making sure our venue is comfortable and easy to visit for everyone. We have a dedicated Access Manager who has overall responsibility for ensuring the venue is as accessible as possible, but also ask everyone who works with us to put access at the heart of their events.

To speak to someone directly, you can contact our events team at [**events@factoryinternational.org**](mailto:events@factoryinternational.org)

SUSTAINABILITY

A photograph of a construction site at night. In the center, a large, leafy green tree stands illuminated. The background is filled with the complex scaffolding and structural elements of a building under construction, with some lights visible. In the foreground, several large, orange, dome-shaped structures, possibly tents or temporary enclosures, are arranged in rows. The overall scene is dark, with the primary light sources being the construction site's lights and the tree's illumination.

On a path towards zero-carbon activity by 2028, we're working with industry partners to test and pilot innovative sustainability technology at Aviva Studios.

We ask all our partners to consider how they can reduce the environmental impact of their events – from encouraging sustainable travel to and from the venue to considering the materials they use. Our experienced events team are always on hand to provide guidance and support in this area.

More information on our sustainability approach or to speak to someone directly, you can contact our events team at events@factoryinternational.org

GET IN TOUCH

Ready to plan your event?

To discuss what's possible at Aviva Studios in more detail, get in touch with our events team at events@factoryinternational.org or for music enquiries at music@factoryinternational.org

AVIVA studios

